

# Strainer PN 25/40 Y-type, with flanged ends and drain-plug 1/2" in cover



- Materials:** Body: GS-C 25, Screen: stainless steel 1.4301, Gasket: graphit reinforced
- Connection:** flanged ends DIN
- Test pressure:** 60 bar
- Specials:** Epoxy paint (wet)inside + outsideRAL 5005, 100-150 microns.

DN	L	A	Mesh-width*	Weight (kg)	Article No.**
15	130	75	0,54	2,50	2032501502
20	150	75	0,54	3,00	2032502002
25	160	90	0,87	4,00	2032502502
32	180	90	0,87	5,00	2032503202
40	200	110	0,87	7,00	2032504002
50	230	120	0,87	11,00	2032505002
65	290	140	0,87	18,00	2032506502
80	310	165	1,32	23,00	2032508002
100	350	220	1,32	31,00	2032510002
125	400	260	1,32	48,00	2032512502
150	480	300	1,32	61,00	2032515002
200	600	360	1,38	153,00	2034020002

\* Fine screens at all nominal diameters mesh width 0,25 mm, free area 37%

\*\* When ordering with fine screen: Article-Nr. + addition "with F-SIEB"

DN	L1	D1	Fo	KVS1	KVS2	Zet1	Zet2	ø G	ø R	P	D	B
15	62	22,5	39 %	2,70	2,50	2,14	2,50	39	27	1,5	40x98 oval	120
20	62	22,5	39 %	8,80	7,10	2,14	2,50	39	27	1,5	40x98 oval	125
25	86	35	38 %	16,90	15,50	2,14	2,55	56	40	1,5	48x78 oval	150
32	86	35	38 %	25,00	20,60	2,58	3,87	56	40	1,5	54x89 oval	170
40	98	45	38 %	38,00	33,20	2,83	3,67	68	51	1,5	70x72	205
50	111	55	38 %	56,00	47,50	3,11	4,36	84	58	1,5	91x95	250
65	121	63	38 %	89,00	72,70	3,51	5,28	95	71	1,5	100x110	285
80	137	77	38 %	127,00	96,80	4,02	6,90	122	98	2,0	121x131	330
100	169	100	36 %	200,00	167,00	3,92	5,63	137	115	2,0	137x145	415
125	198	120	36 %	332,00	284,00	3,49	4,77	155	126	1,5	175x190	484
150	239	150	36 %	494,00	389,00	3,26	5,26	220	180	2,0	Ø 306	535
200	290	186	36 %	675,00	570,00	5,50	7,60	260	212	2,0	Ø 345	720

The delivery of the strainer is in accordance to PED 2014/68/EU Point 11 and 12 of the preamble and article 1, clause c as well as article 4, clause 3. The picture shown is only a symbolic photo! Subject to technical changes and errors.

## Key for our datasheets

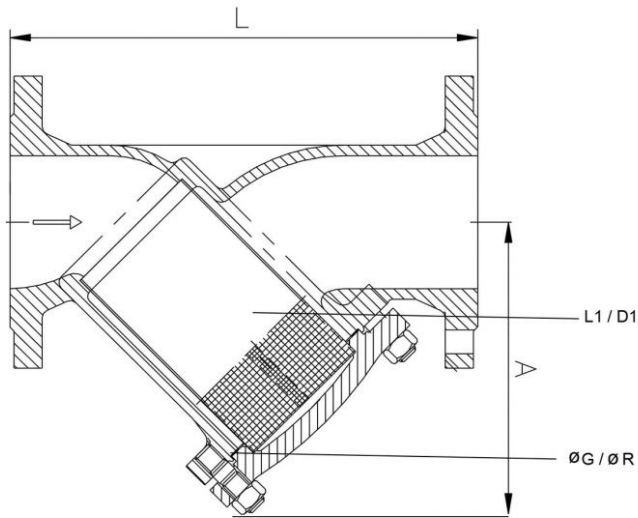

DN	Nominal diameter
L	Face to face dimension (mm)
A	Centre line of pipe to end of cover (mm)
L1	Screen length (mm)
D1	Screen diameter (mm)
Fo	Free screen area standard element (mm)
KVS1	KVS-Value standardscreen (m <sup>3</sup> /h)
KVS2	KVS-Value fine screen (m <sup>3</sup> /h)
Zet1	Zeta-Value standardscreen
Zet2	Zeta-Value fine screen
ø G	Outer-diameter coverflange gasket (mm)
ø R	Inner-diameter coverflange gasket (mm)
P	Thickness coverflange gasket (mm)
D	Coverflange size
B	Distance required to remove screen (mm)