

# Strainer PN 6 Y-type, with flanged ends and drain-plug 1/2" BSP in cover



- Materials:** Body: cast iron JL 1040, Screen: stainless steel 1.4301 (from DN 150 perforated plate 1.4301), Gasket: graphit reinforced
- Connection:** flanged ends DIN
- Test pressure:** 9 bar
- Specials:** with connection for differential gauge in body DN 15 - DN 40 G 1/4" and DN 50 - DN 250 G 1/2". Valves made of cast iron are not authorized for use in systems subject TRD110.

DN	L	A	Mesh-width*	Weight (kg)	Article No.**
15	130	75	0,50	2,20	96006015GLT
20	150	75	0,50	3,30	96006020GLT
25	160	90	0,75	3,80	96006025GLT
32	180	90	0,75	5,00	96006032GLT
40	200	110	0,75	6,80	96006040GLT
50	230	120	0,75	7,50	96006050GLT
65	290	140	0,75	11,20	96006065GLT
80	310	165	0,75	15,40	96006080GLT
100	350	220	1,20	23,20	96006100GLT
125	400	260	1,20	33,50	96006125GLT
150	480	300	1,20	47,10	96006150GLT
200	600	360	1,20	99,50	96006200GLT

\* Fine screens at all nominal diameters mesh width 0,25 mm, free area 37%

\*\* When ordering with fine screen: Article-Nr. + addition "with F-SIEB"

DN	L1	D1	Fo	KVS1	KVS2	Zet1	Zet2	ø G	ø R	P	D	B
15	53	25	39 %	5,60	5,50	2,58	2,68	49	40	1,0	70x70	115
20	53	25	39 %	10,70	10,30	2,24	2,41	49	40	1,0	70x70	115
25	66	31	38 %	17,60	16,26	2,02	2,6	55	46	1,0	75x75	135
32	71	38	38 %	29,15	26,60	1,97	2,37	55	46	1,0	75x75	135
40	91	47	38 %	46,10	41,80	1,93	2,34	67	56	1,0	90x90	170
50	105	57	38 %	71,60	63,70	1,95	2,46	74	66	1,0	98x98	190
65	123	73	38 %	119,50	105,40	2,00	2,57	94	83	1,0	111x111	220
80	144	88	36 %	173,50	144,00	2,18	3,16	109	100	1,0	136x136	265
100	184	108	36 %	217,50	196,70	3,38	4,14	134	120	1,0	ø 194	340
125	219	135	36 %	364,40	320,00	2,94	3,81	158	138	1,5	ø 234	410
150	258,5	160	36 %	537,00	468,00	2,81	3,70	180	162	1,5	ø 264	475
200	360	208	36 %	820,00	769,00	3,81	4,33	240	209	2,0	ø 290	580

The delivery of the strainer is in accordance to PED 2014/68/EU Point 11 and 12 of the preamble and article 1, clause c as well as article 4, clause 3.

The picture shown is only a symbolic photo! Subject to technical changes and errors.

## Key for our datasheets

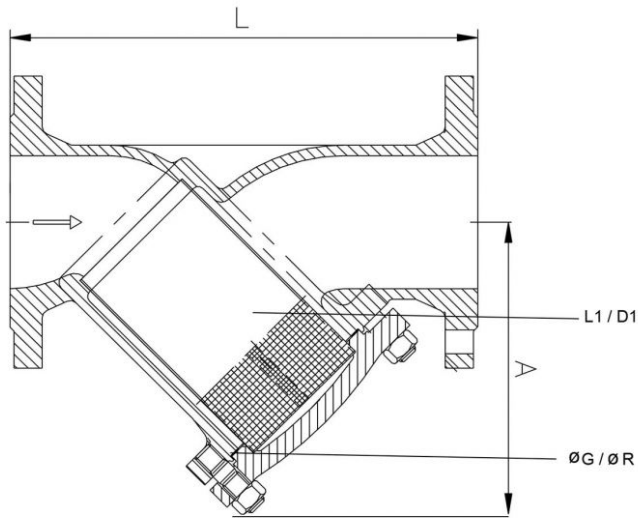

DN	Nominal diameter
L	Face to face dimension (mm)
A	Centre line of pipe to end of cover (mm)
L1	Screen length (mm)
D1	Screen diameter (mm)
Fo	Free screen area standard element (mm)
KVS1	KVS-Value standardscreen (m <sup>3</sup> /h)
KVS2	KVS-Value fine screen (m <sup>3</sup> /h)
Zet1	Zeta-Value standardscreen
Zet2	Zeta-Value fine screen
ø G	Outer-diameter coverflange gasket (mm)
ø R	Inner-diameter coverflange gasket (mm)
P	Thickness coverflange gasket (mm)
D	Coverflange size
B	Distance required to remove screen (mm)